

PLAT OF SURVEY – TITLE SURVEY
LOT 1 OF CERTIFIED SURVEY MAP NO. 4651
LOCATED IN PART OF THE NW 1/4 OF THE NW 1/4 OF SECTION 36, TOWN R NORTH, RANGE 16 EAST,
TOWN OF LAGRANGE, WALWORTH COUNTY, WISCONSIN

Lot 1 of Certified Survey Map No. 4651, recorded on May 20, 2016 in Volume 30 of Certified Survey Maps, page 296, as Document No. 925523, a parcel consolidation CSM between Lots 13, part of Lot 15 of Pleasant Point Subdivision and unplatted lands, located in the Northwest 1/4 of the Northwest 1/4 of Section 36, Town 4 North, Range 16 East, Town of LaGrange, Walworth County, Wisconsin.

TOGETHER WITH AND SUBJECT TO an easement for ingress and egress depicted on Certified Survey Map No. 4815 recorded December 13, 2018 as Document No. 980081.

LEGAL DESCRIPTION OF RECORD PER OLD REPUBLIC NATIONAL TITLE INSURANCE COMPANY,
COMMITMENT NUMBER: 923040276 DATED: APRIL 18, 2023

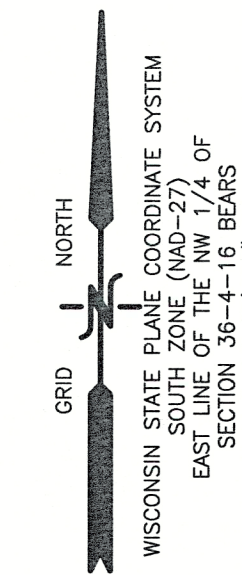

- LEGEND
- = IRON PIPE FOUND 1 3/8" O.D.
 - = IRON REBAR FOUND 3/4" O.D.
 - ⬤ = BENCHMARK
 - ⊕ = UTILITY POLE
 - {xxx} = RECORDED AS
 - OH — = OVERHEAD UTILITY WIRES

LOT 1
CSM 4651
10,170 SQ. FT.
(0.23 ACRES)

MAP SCALE IN FEET – ORIGINAL 1"=10'

NOTE: COPIES OF THIS MAP TO WHICH THE FOLLOWING CERTIFICATE WILL APPLY SHOW THE SURVEYOR'S ORIGINAL SEAL AND SIGNATURE IN RED INK. COPIES BY ANY OTHER MEANS MAY HAVE ALTERATIONS WHICH DO NOT REPRESENT THE SURVEYOR'S WORK PRODUCT.

I HEREBY CERTIFY THAT THE ABOVE DESCRIBED PROPERTY HAS BEEN SURVEYED UNDER MY DIRECTION AND THAT THE ABOVE MAP IS A TRUE REPRESENTATION THEREOF AND SHOWS THE SIZE AND LOCATION OF THE PROPERTY, ITS EXTERIOR BOUNDARIES, THE LOCATION OF ALL VISIBLE STRUCTURES, AND DIMENSIONS OF ALL PRINCIPLE BUILDINGS THEREON, BOUNDARY FENCES, APPARENT EASEMENTS, ROADWAYS, AND VISIBLE ENCROACHMENTS, IF ANY. THIS SURVEY IS MADE FOR THE USE OF THE PRESENT OWNERS OF THE PROPERTY, AND ALSO THOSE WHO PURCHASE, MORTGAGE, OR GUARANTEE THE TITLE THERETO WITHIN ONE YEAR FROM THE DATE HEREOF.

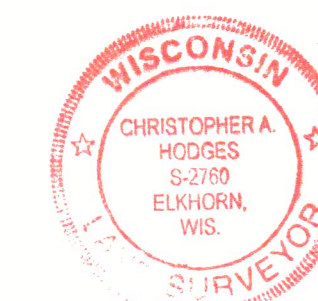

DATED: 5/17/2023

CHRISTOPHER A. HODGES P.L.S. 2760

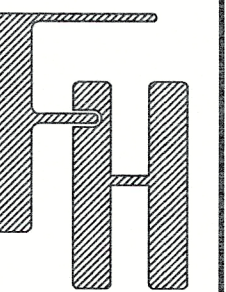

TITLE SURVEY
N7630, PLEASANT POINT CIRCLE
ELKHORN, WI 53121

WORK ORDERED BY –
VINCENT AND PAMELA MCHUGH
W6292 LAUDERDALE DRIVE
ELKHORN, WI 53121

FARRIS, HANSEN & ASSOCIATES, INC.
ENGINEERING – ARCHITECTURE – SURVEYING
7 RIDGWAY COURT P.O. BOX 437
ELKHORN, WISCONSIN 53121
PHONE: (262) 723-2098 e-mail: office@farris-hansen.com

REVISIONS

PROJECT NO.
9470.23

DATE
5/17/2023

SHEET NO.
1 OF 1